



AMERICA'S CORVETTE CLUB Presents:
OUR 25TH ANNIVERSARY!!!
"REFLECTIONS IN GLASS XXV"
Corvette & GM Car & Truck Shows

SPONSORED BY LOU BACHRODT CHEVROLET
COCONUT CREEK & POMPANO BEACH, FLORIDA - OUR CLUB'S LIFETIME SPONSOR!

Date: **Saturday, January 19, 2008 - RAIN OR SHINE!**
 Time: **10 AM - 5 PM** (Registration 8:30 am - 11:00 am)
 Show Location: **Mission Bay Plaza - NW corner of Glades Rd & SR 7 (US 441)**
Boca Raton, Florida

One of the largest judged Corvette shows in Florida with nearly 200 'Vettes in past years!
NEW FOR 2008! THE ADDITION OF A GM CAR & TRUCK SHOW
TWO GREAT SHOWS IN ONE LOCATION

Registration Fee: **\$30.00 by January 12, 2008 * OR**
\$35.00 on the day of the Shows

***FREE T-SHIRTS TO 1ST 100 PRE-REGISTERS!**

- Cars not registered and in place by 11:30 am will NOT be judged.
- All entries will be assigned a parking spot upon arrival.
- Judging begins at 12:00 noon SHARP!

Awards: **1st & 2nd place in each class**
Specialty awards

Club participation for Corvette Show..... **1st \$100.00 2nd \$50.00**
 Club participation for GM Cars & Trucks Show..... **1st \$100.00 2nd \$50.00**

Judged Event
 Total of 63 Judged Classes

NOTE: Display Class cars will count towards Club Participation but will not be eligible for any individual awards.

A portion of the proceeds to benefit local charities!

JUDGING CLASSIFICATIONS

JUDGED CLASSES FOR CORVETTES

ORIGINAL (0-3 CHANGES)

- 1953-1962
- 1963-1967
- 1968-1982
- 1984-1990
- 1991-1996
- 1997-2004
- 2005-2008

MODIFIED (4-10 CHANGES)

- 1953-1962
- 1963-1967
- 1968-1982
- 1984-1990
- 1991-1996
- 1997-2004
- 2005-2008

CUSTOM (11+ CHANGES)

- 1953-1982
- 1984-2008

STREET (EXTERIOR, INTERIOR, ENGINE)

- 1953-1962
- 1963-1967
- 1968-1982
- 1984-1990
- 1991-1996
- 1997-2004
- 2005-2008

WASH & SHOW (EXTERIOR, INTERIOR)

- 1953-1962
- 1963-1967
- 1968-1982
- 1984-1990
- 1991-1996
- 1997-2004
- 2005-2008

DISPLAY (NOT JUDGED) 1953-2008

JUDGED CLASSES FOR GM CARS & TRUCKS

ORIGINAL (0-3 CHANGES)

- 1900-1940
- 1941-1954
- 1955-1957
- 1958-1962
- 1963-1969
- 1970-1976
- 1977-1985
- 1986-1992
- 1993-1999
- 2000-2001
- 2002-2004
- 2005-2008

MODIFIED (4-10 CHANGES)

- 1900-1935
- 1936-1942
- 1943-1948
- 1949-1954
- 1955-1957
- 1958-1962

- 1963-1969
- 1970-1976
- 1977-1990
- 1991-1999
- 2000-2003
- 2004-2008

CUSTOM (11+ CHANGES)

- 1949-1982
- 1983-2008

WASH & SHOW (EXTERIOR, INTERIOR)

- 1900-1962
- 1963-1967
- 1968-1983
- 1984-1990
- 1991-1996
- 1997-2004
- 2005-2008

DISPLAY (NOT JUDGED) 1900-2008

Music: MUSIC BY DJ "SCOTT THE MUSIC MAN"

Food & Beverages: AVAILABLE WITHIN MISSION BAY PLAZA

50-50 Drawing

Door Prizes

Silent Auction

For more information contact an America's Corvette Club member at:
 S. Broward/Dade: 954-985-8310 N. Broward: 954-481-9763 Palm Beach: 561-963-9848
 Or visit our website at: www.americascorvetteclub.com E-mail: acc1983@yahoo.com

America's
Corvette
Club
Car Show

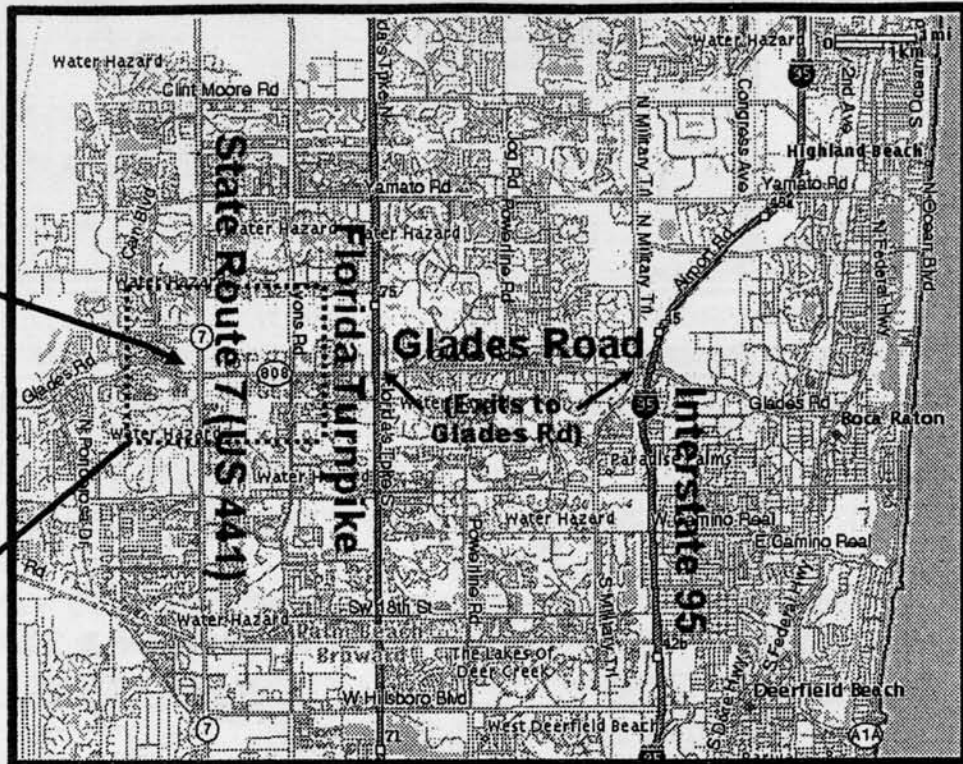

NOTE: There are exits to Glades Road from both I-95 and the Florida Turnpike.

Area
Detail

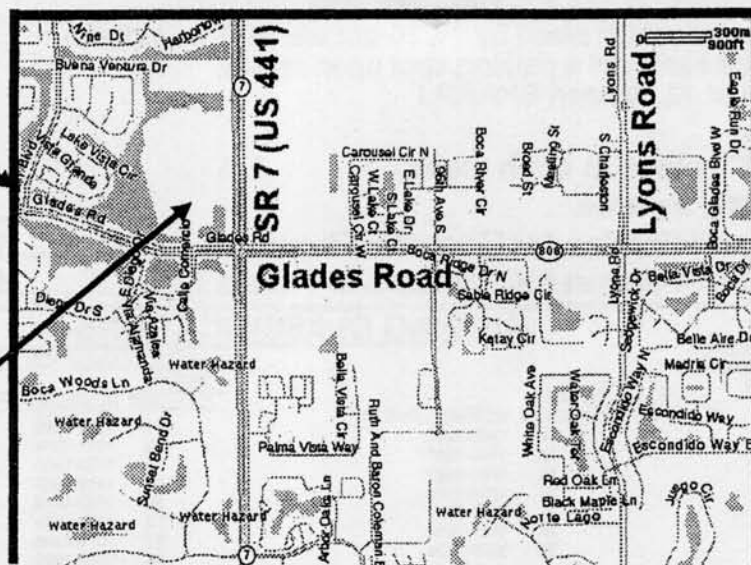

America's
Corvette
Club Car Show
(Mission Bay Plaza)

FOR ADDITIONAL MAP & DIRECTIONS GO TO WWW.PREMIUMCARSHOWS.COM AND CLICK ON THE JANUARY 19, 2008 LISTING.

Please Print Clearly!

REGISTRATION FORM

Please Print Clearly!

Name(s) _____ Phone (____) _____

Address _____

City _____ State _____ Zip _____

Club Affiliation (if any) _____ E-Mail _____

(Enter the primary Club only. Do not abbreviate, please)

Corvette Year: _____ GM Year: _____
 Body Style: (Check only one box above style) Coupe Sedan Convertible Hardtop Truck

Requested Class: (Please check only one, even if unsure)

Original Modified Street (Corvettes only)
 Custom Wash and Show Display (non-judged)

Send registration and checks payable to: **Premium, 8480 49th Street North, Pinellas Park, FL 33781**

To register up to 2 days before show using or Call 727-547-8082

For more information call (727) 547-8082 or visit www.premiumcarshows.com to register online

It is agreed that all persons who enter for exhibition and competition purposes in the show will abide by the rules set forth by the show management. It is also agreed that neither the show producer nor the owners of the grounds in which the show is held, shall be responsible to me for personal injury, damage or theft of any part of my entry or display.

No entry accepted without signature.

SIGNED _____